

PALISADE



PALISADE

Palisade Tables are manufactured with Berco's goal of quality and value and are ideally suited for use in a myriad of settings including corporate training rooms, cafeterias, educational settings and healthcare environments. Your choice of options make our Palisade tables adapt to your specific requirements.

Table Pedestal Specifications Finishes: Available in textured standard powder coat finishes. Custom finishes available. Please contact Customer Service for quotation.

Construction: Made with a 1 1/4" 16 gauge cold rolled steel tubing welded to a 6 X 6.2" thick steel mounting plate designed to place the legs into the corner of the tops. For tops greater than 48" length, a table stiffener is added to diminish the possibility of top warpage. Legs are shipped, assembled, and ready to attach to the tops.

Glides and Casters: All tables are equipped with 2" diameter glides with brushed stainless steel cover over black plastic foot. The stem is M10 and 15mm long. The glide is suitable for carpet, as well as hard floors. Our high quality twin wheel locking casters are offered as an option.

PALISADE BASE SPECIFICATIONS

Pedestal



Smart Code

PAL-1

Base Size

N/A

Column Diameter

1 ¼"

Top Capacity

Distance Between Legs
Over 48" Up To 72"
Requires Stiffener

PALISADE DESIGN OPTIONS

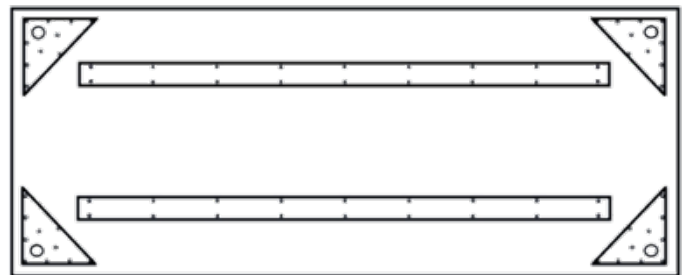
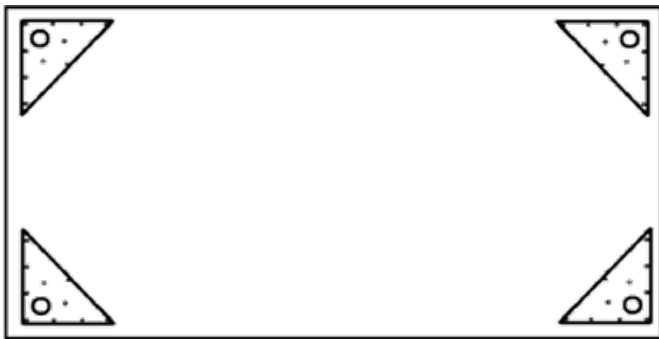
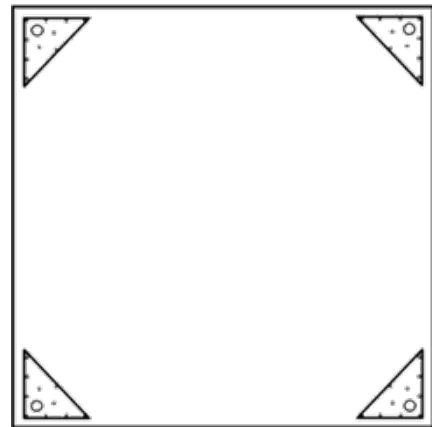
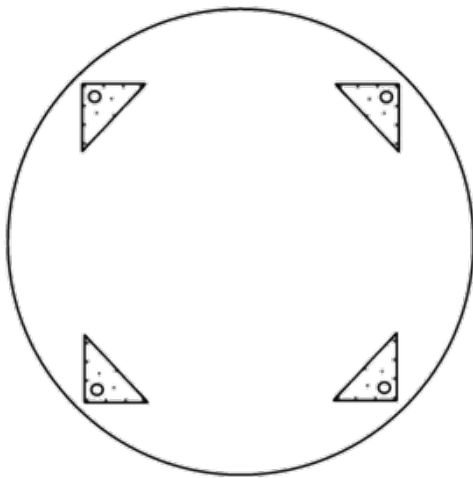

PALISADE TABLES - (LAMINATE - PVC EDGE)

Limited Base Finish Options - Textured Only



Edge Choice: PVC & T-Mold			Laminate Upgrades		Light Weight	OPTIONS			
			Laminate Upgrade I	Laminate Upgrade II	Light Weight (PVC only - 1" top)	DELUXE CASTERS (BLK)	EQUALIZER GLIDES	UPGRADE FINISH (5 TABLES MIN.)	
			ADD	ADD	ADD	ADD	ADD	ADD	
SQUARE (SQR)									
PAL	30x30	\$752	\$790	\$56	\$150	\$132	\$174	\$65	\$145
PAL	36x36	\$852	\$894	\$64	\$170	\$149	\$174	\$65	\$145
PAL	42x42	\$966	\$1,014	\$72	\$193	\$169	\$174	\$65	\$145
ROUND (RND)									
PAL	36	\$877	\$921	\$66	\$175	\$154	\$174	\$65	\$145
PAL	42	\$988	\$1,037	\$74	\$198	\$173	\$174	\$65	\$145
PAL	48	\$1,113	\$1,169	\$84	\$223	\$195	\$174	\$65	\$145
RECTANGLE (REC)									
PAL	18x36	\$680	\$714	\$51	\$136	\$119	N/A	\$65	\$145
PAL	18x42	\$716	\$752	\$54	\$143	\$125	N/A	\$65	\$145
PAL	18x48	\$754	\$791	\$57	\$151	\$132	N/A	\$65	\$145
PAL	18x60	\$1,065	\$1,118	\$80	\$213	\$186	N/A	\$65	\$145
PAL	18x72	\$1,376	\$1,445	\$103	\$275	\$241	N/A	\$65	\$145
PAL	24x36	\$745	\$782	\$56	\$149	\$130	\$174	\$65	\$145
PAL	24x42	\$783	\$823	\$59	\$157	\$137	\$174	\$65	\$145
PAL	24x48	\$822	\$863	\$62	\$164	\$144	\$174	\$65	\$145
PAL	24x60	\$1,148	\$1,205	\$86	\$230	\$201	\$174	\$65	\$145
PAL	24x72	\$1,474	\$1,548	\$111	\$295	\$258	\$174	\$65	\$145
PAL	30x36	\$798	\$838	\$60	\$160	\$140	\$174	\$65	\$145
PAL	30x42	\$844	\$886	\$63	\$169	\$148	\$174	\$65	\$145
PAL	30x48	\$890	\$935	\$67	\$178	\$156	\$174	\$65	\$145
PAL	30x60	\$1,231	\$1,293	\$92	\$246	\$215	\$174	\$65	\$145
PAL	30x72	\$1,490	\$1,565	\$112	\$298	\$261	\$174	\$65	\$145